

# TH90cn-2,5 100 BAR

**ACTH925C**



Ratio  
Rapporto  
**1:1**



RPM  
Velocità  
**9.000 min<sup>-1</sup>**



RPM Dry running  
Velocità a secco  
**6.000 min<sup>-1</sup>**



Max. axial load  
Max. carico assiale  
**510 N**



Torque  
Momento torcente  
**30 Nm**



Weight  
Peso  
**5,5 kg**



Collet  
Pinza  
**ER-25 (ø 1/16 mm)**

\* STANDARD EQUIPMENT INCLUDES:

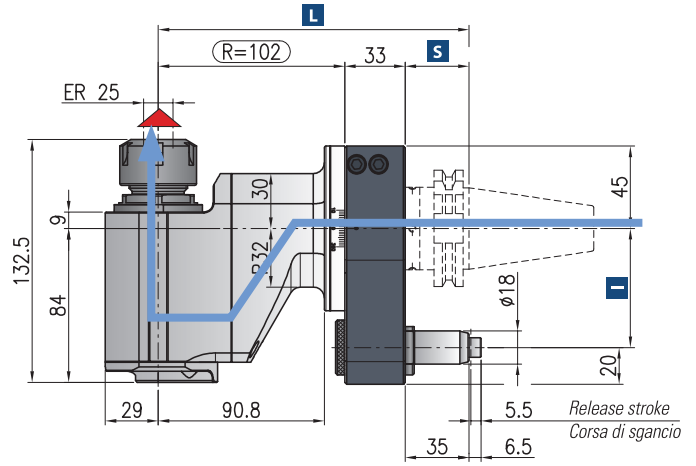
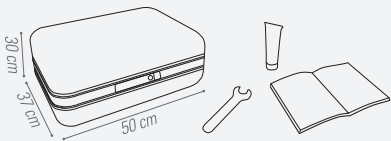

Minimum diameter without tool  
Diametro minimo senza utensile

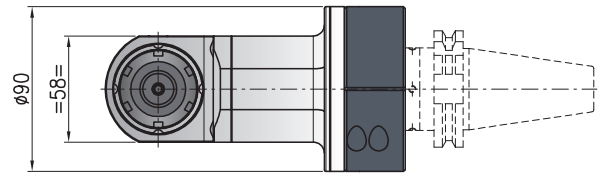
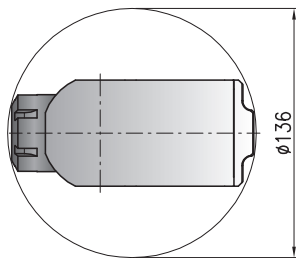

Retaining block / Tassello di ritegno / Stop-Block  
**NOT INCLUDED - NON INCLUSO**



Dry running also possible / Rotazione a secco possibile

▲ Direction of rotation opposite to machine spindle / senso di rotazione contrario al mandrino

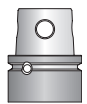
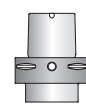
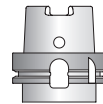
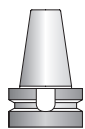
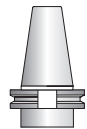
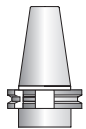

Shank/Cono	DIN-69871	CAT	MAS-BT	HSK	CAPTO	KM			
Size/Grandezza	40	50	40	50	63-80	100	C5-C6	C8	63
<b>I</b>	65-80	80-(110*)	65-80-(110*)	80-(110*)	65-80-(110*)	80-(110*)	65-80-(110*)	80-(110*)	65-80-(110*)
<b>S</b>	35	35	35	41	42	45	38	40	40
<b>L</b>	170	170	170	176	177	180	173	175	175

Dual contact spindles available/Disponibilità coni a doppio contatto

\*optional

Non interchangeable input drive shank/ Coni di attacco non intercambiabili

Opzione / Option



Ø mm max.

16

Weldon output  
Weldon

# TH90cn-2,5 L 100 BAR

## ACTH925L

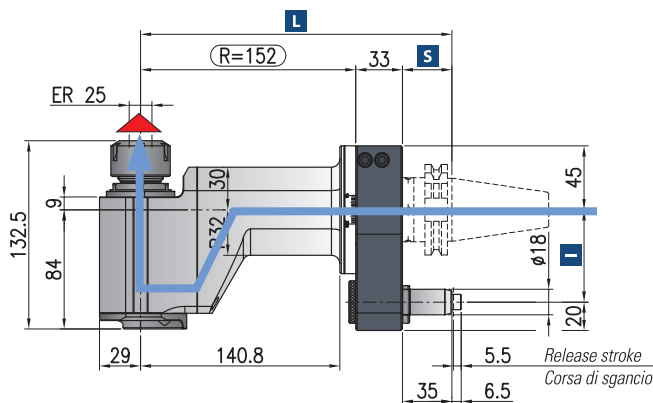

Minimum diameter without tool  
Diametro minimo senza utensile

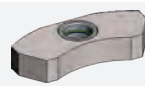
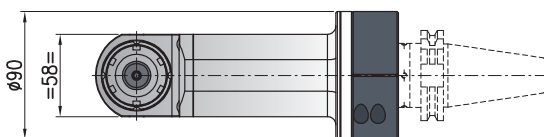
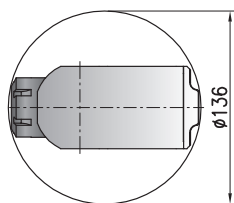

Retaining block / Tassello di ritegno / Stop-Block  
**NOT INCLUDED - NON INCLUSO**

▲ Direction of rotation opposite to machine spindle / *sensò di rotazione contrario al mandrino*



Ratio  
Rapporto  
**1:1**



RPM  
Velocità  
**4.000 min<sup>-1</sup>**



Max. axial load  
Max. carico assiale  
**510 N**



Torque  
Momento torcente  
**30 Nm**



Weight  
Peso  
**6,8 kg**



Collet  
Pinza  
**ER-25(Ø2/16mm)**

\* STANDARD EQUIPMENT INCLUDES:

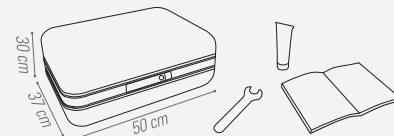

Shank/Cono	DIN-69871	CAT	MAS-BT	HSK		CAPTO		KM
Size/Grandezza	50		50	63-80	100	C6	C8	63
<b>I</b>	80-110		80-110	80-110	80-110	80-110	80-110	80-110
<b>S</b>	35		41	42	45	38	40	40
<b>L</b>	250		256	257	260	253	255	255

Dual contact spindles available/Disponibilità coni a doppio contatto

\*optional

Non interchangeable input drive shank/ Coni di attacco non intercambiabili

Opzione / Option



Ø mm max.  
**16**

Weld on output  
Weld on